

CERAMIC HEATING

GAS LUMINOUS HEATERS



**INDUSTRIAL
and
PUBLIC
Buildings**



*Manufacturer
industrial
heating*

How to HEAT an INDUSTRIAL or PUBLIC building ...

Optimizing the heating of an industrial or public building requires that a professional take specific data into account :

■ Building's intended use :

industrial manufacturing, logistics, warehouses, vehicle maintenance and repair, sports halls, religious buildings, restaurant terraces, etc.

■ Building structure :

new or old, well or poorly insulated, mechanical or natural ventilation, permanent openings, travelling cranes, etc.

■ Temperature needs :

climatic conditions, general or zone heating, etc.

■ Height and shape of the building

■ Specific restrictions related to the heaters :

size, aesthetics, sound level, ...



INDUSTRIAL MANUFACTURING



LOGISTICS



WAREHOUSE



SPORTS HALL



TERRACE



VEHICLE REPAIR



RELIGIOUS BUILDING



INDOOR TENNIS COURTS

Gas ceramic heating, with its flexibility, makes it possible to perfectly match the proposed solution with the project specifications, all while guaranteeing economical use of energy. This technology is particularly appropriate for buildings having a height greater than 4 meters.

A 3-step procedure for quality

① PROJECT TECHNICAL SPECIFICATIONS

② CUSTOMIZED TECHNICAL SURVEY

③ MANUFACTURER AND NETWORK REFERENCES

- Industrial manufacturing
- Logistics
- Warehouses
- Sports halls
- Religious buildings
- Restaurant terraces
- Vehicle repair
- Indoor tennis courts

...

www.sbm-international.net

CERAMIC HEATING

GAS LUMINOUS HEATERS

"The less polluting energy is the one which is not consumed"

■ Ceramic heating reduces gas consumption by 30% to 40% as compared to conventional heating techniques. It helps protect our environment by reducing greenhouse gas emissions (CO₂).

■ Gas combustion in the high temperature ceramic plates is complete, so ceramic heaters can be installed safely without any chimney connected to the outside (European standard EN 13410). The air quality and hygiene conditions inside the building are kept optimum.

■ SBM luminous heaters are certified as being in the best category (EN 419-2, class 4) for respecting the environment. Nitrogen oxide (NO_x) levels in the combustion products are at least 10 times below the limits established by European standards.



ECONOMY
COMFORT
ENVIRONMENT

The growing cost of energy is leading many owners or managers to optimize the energy performance of their buildings, all while maintaining productivity at the maximum level. Heating is among the top priorities.

- **Energy SAVINGS**
- **COMFORT for the personnel**
- **RESPECT of the environment**



ONE OBJECTIVE :
heating budget reduced by 30% to 40% per year

HEAT the SURFACES, NOT the VOLUMES

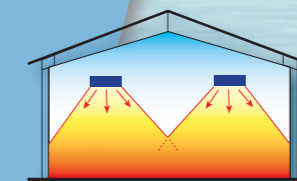

heated **SURFACES**
ceramic heating

Heat sent directly to the floor, machines and occupants.



heated **VOLUMES**
traditional heating

Heat dispersed throughout the volume of the building.



HEAT QUICKLY

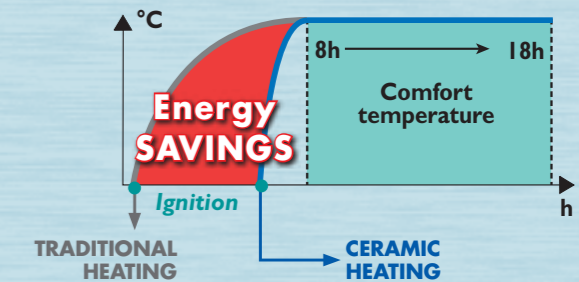

After ignition, 95% of the energy emitted is reached within 5 minutes.



HEAT only WHERE NEEDED

Packing +17° Monday to Friday : 8.00 - 12.00 • 14.00 - 18.00		Storage +4°	
Manufacturing +20° Monday to Friday : 8.00 - 12.00 • 14.00 - 18.00		Offices +15° Monday to Friday : 8.00 - 17.00	

The comfort temperature can be selected to suit your specific requirements (working areas, times and days).

www.sbm-international.net

CERAMIC HEATING

GAS LUMINOUS HEATERS

■ **Ceramic heating** is a natural way of heating, based on the principle of infrared. It heats surfaces, not volumes.

■ **Ceramic heating** offers direct heat for the floor, machines, and occupants. The air within the building is heated indirectly by the reflected energy.

■ **Ceramic heating** does not overheat the upper parts of the building. It focuses energy where it is best used, thus reducing gas consumption to the strict minimum.

■ **Ceramic heating** is silent, and creates no draughts or dust movements. It does not require any moving mechanical parts.

- **Lightweight and compact**

- **Environment friendly and silent**

- **Easy to use and maintain**



ECONOMY
COMFORT
ENVIRONMENT



For every need
a complete
heating line

MODULAR LINE OF HEATERS
from 2.5 kW to 27 kW and more

■ Selection from among 9 different sizes, guaranteeing an ideal comfort level, regardless of the heaters installation height.

■ **"TWO-SPEED"** option to optimize heating comfort and performance in **well-insulated buildings**.

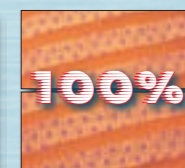
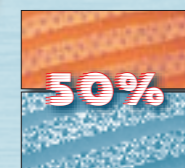

"TWO-SPEED"
technology
by SBM

■ Gas energy, propane or natural gas.



**Programmable
control units**



www.sbm-international.net

Specialized SURVEY DEPARTMENT at your service

Whether your project is small or large, request your customized heating survey, free of charge and without any commitment.

Our survey department, specializing in heating industrial and public buildings, will provide you with a detailed project file that meets your specifications and is perfectly suited to your needs.



Customized heating survey
free of charge
and without any commitment

YOUR HEATING PROJECT FILE includes :

- Customized drawings
- Computation of required heat capacity
- Selection of heater size
- Heaters lay-out
- Sizing of gas piping
- Temperature guarantee

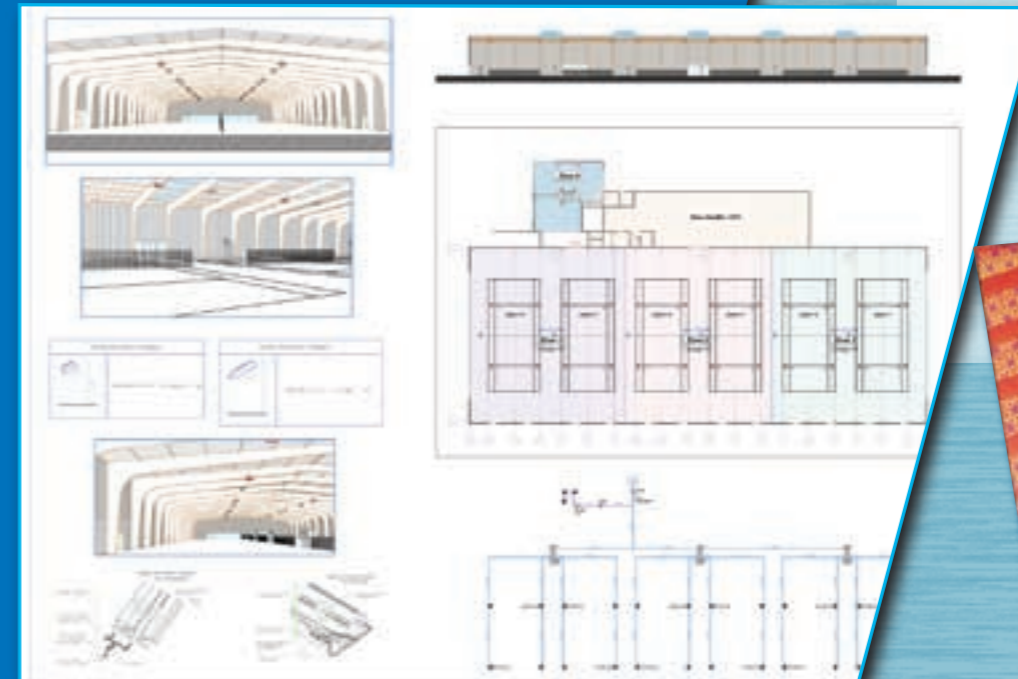
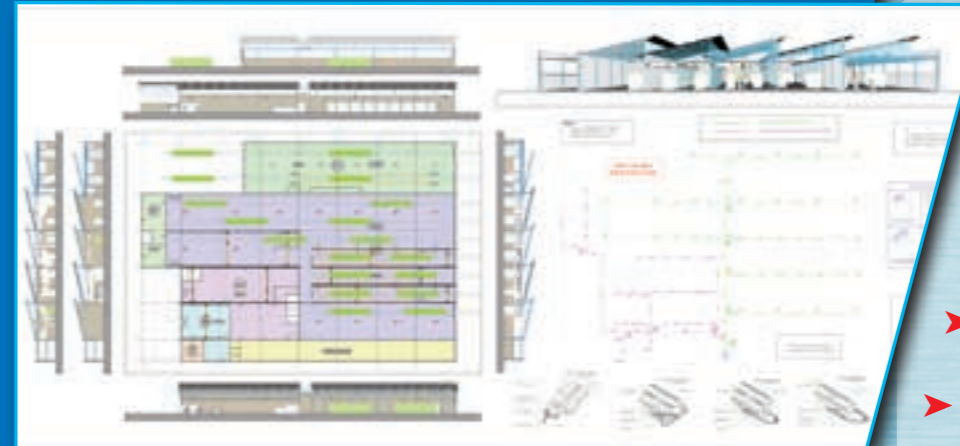

www.sbm-international.net



SBM : international manufacturer of industrial heating

- 70% of production exported
- NETWORK of DISTRIBUTORS and INSTALLERS in more than 60 countries

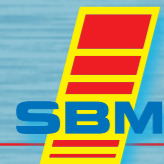

Manufacturer
industrial
heating



- Industrial manufacturing
- Logistics
- Warehouses
- Sports halls
- Religious buildings
- Restaurant terraces
- Vehicle repair
- Indoor tennis courts
- ...

Manufacturer and network references

Thousands of satisfied customers in more than 60 countries :
Small/medium-sized companies or international corporations

- ACERINOX • ALSTOM • ALCAN
- ARBEL • ARMÉE DE TERRE • ASCA
- BASILIQUE DE LOURDES
- BERGERAT MONNOYEUR
- BLOND BAUDOIN • BONDUELLE
- BOULODROME CARCASSONNE
- BOULODROME STE LIVRADE
- CROWN CORK • CREUZET
- CENTRE de SECOURS LAVARDAC
- DAIMLER CHRYSLER • DCAN • DCM
- GIAT INDUSTRIE • IMERYS • KERAGLASS
- GYMNASSE DE GIF sur YVETTE
- LIGUE de BOURGOGNE de TENNIS
- MARINE NATIONALE
- MIROITERIE DE L'EST • PONT À MOUSSON
- POTAIN • PROFILAFROID • RENAULT TRUCKS
- ROCAMAT • SAINT-GOBAIN • S.E.E.B. • S.N.C.F.
- SOCOFER • STEIN FASEL • TECHNAL • TRAILOR
- TUBALCO • UGINE STEEL • VAL D'AUCY
- VALLOUREC • • •

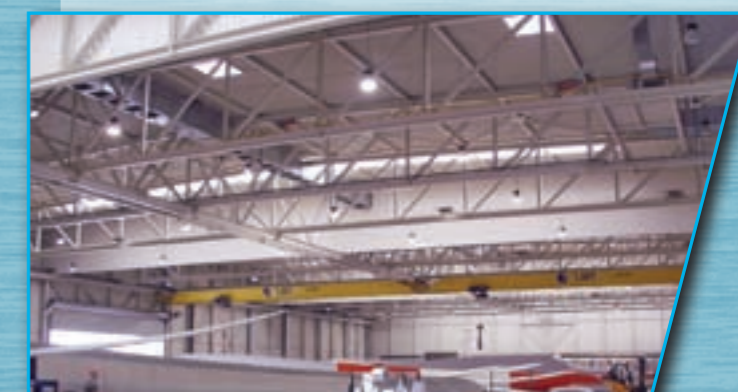

www.sbm-international.net



*Manufacturer
industrial
heating*

www.sbm-international.net

-  **Industrial manufacturing**
-  **Logistics**
-  **Warehouses**
-  **Sports halls**
-  **Religious buildings**
-  **Restaurant terraces**
-  **Vehicle repair**
-  **Indoor tennis courts . . .**

CERAMIC HEATING

GAS LUMINOUS HEATERS

*Thousands of satisfied customers
in more than 60 countries*

SBM International

**3 Cottages de la Norge
21490 CLENAY**

Tél : (+33) 3 80 76 74 80

Fax : (+33) 3 80 76 74 89

E-mail : sbm.com@sbm.fr

www.sbm-international.net

Distributed by :